

LATTICE PATIO COVER

INSTALLATION INSTRUCTIONS

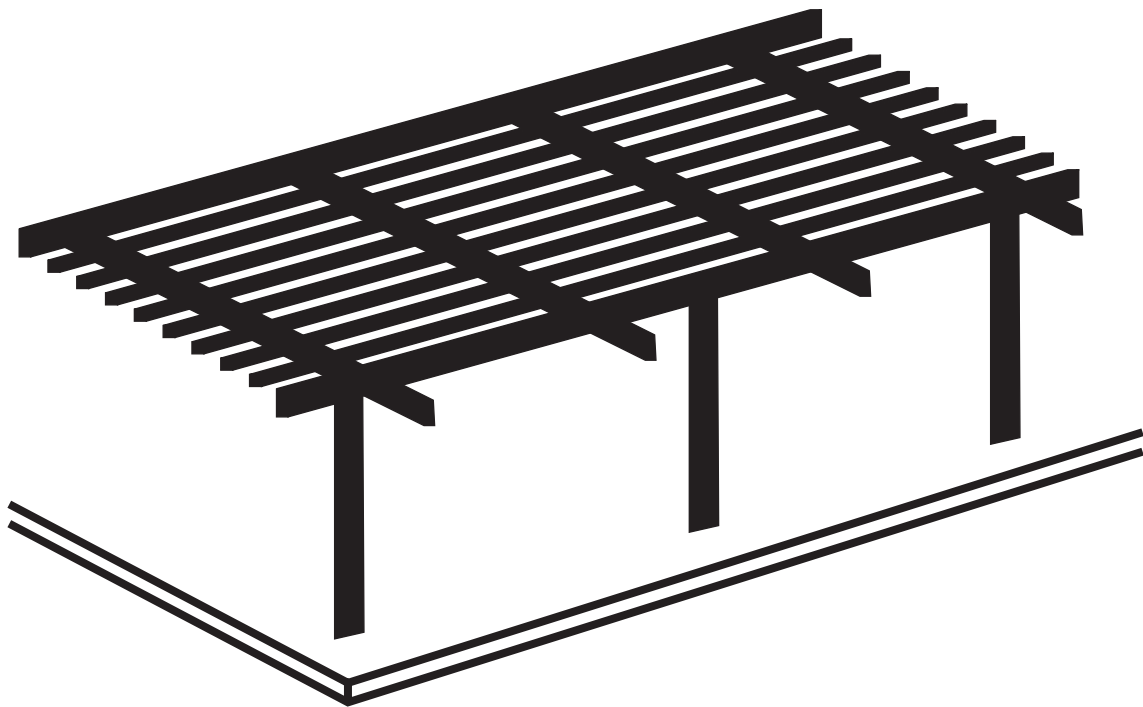

GENERAL INFORMATION: THESE LATTICE PATIO COVERS ARE DESIGNED TO BE ATTACHED UNITS. THEY ARE DESIGNED TO RESIST A 10 PSF (NON-SNOW AREA), A 20 PSF (MODERATE SNOW AREA), AND A 30 PSF, (HEAVY SNOW AREA) LIVE LOADS. REQUIREMENTS FOR BUILDING PERMITS VARY WITH GEOGRAPHIC LOCATIONS.

PARTS DIAGRAM

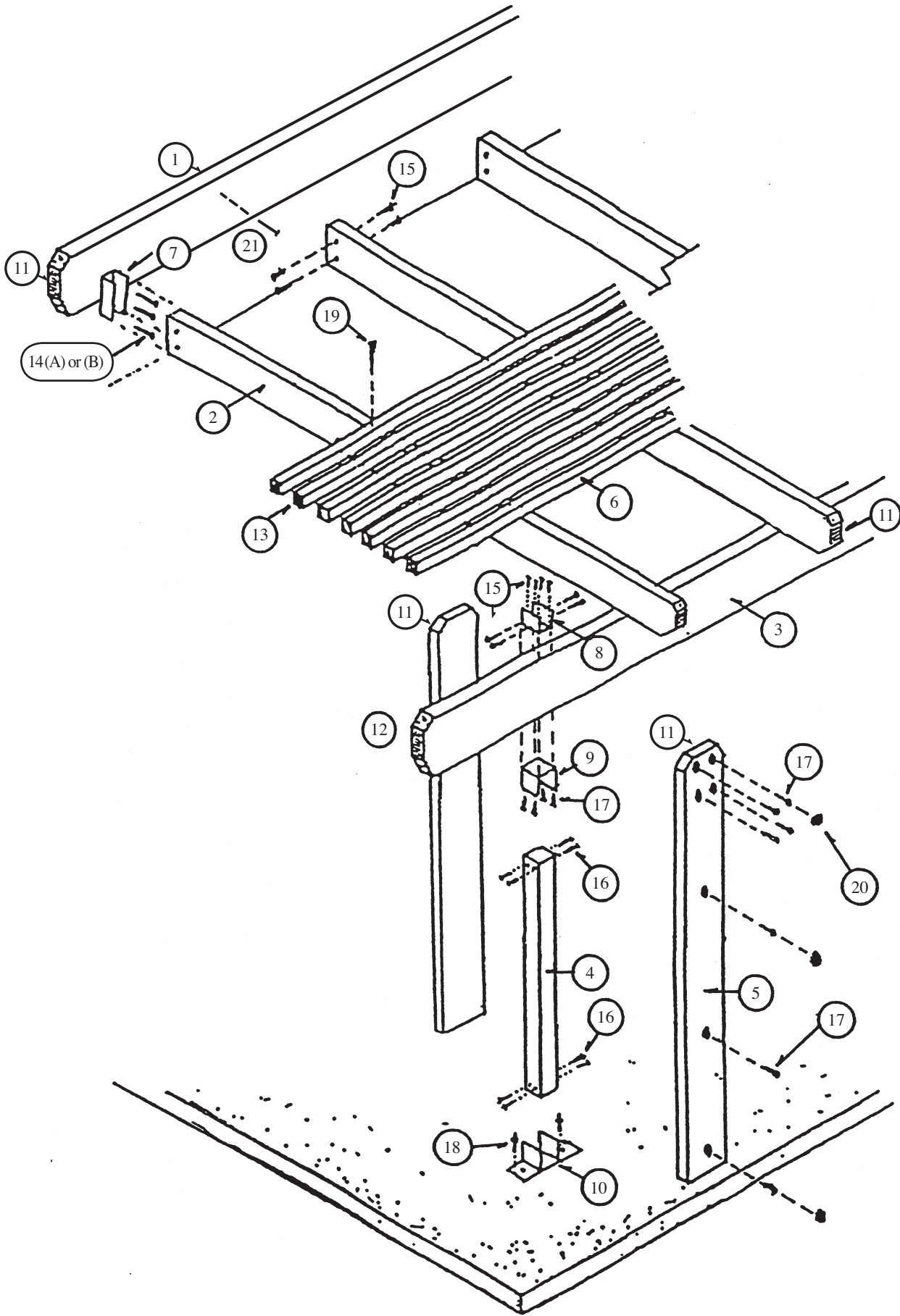

PARTS LIST

LATTICE COMPONENTS

ITEM NO.	DESCRIPTION
1-	2" X 6-1/2" LEDGER BOARD KIT W/ WOOD INSERTS
2-	2" X 6-1/2" RAFTER
3-	3" X 8" HEADER BEAM
4-	3" X 3" SQUARE POST
5-	2" X 6-1/2" FOAM FILLED SIDE PLATE
6-	2" X 2" SQUARE LATTICE TUBE

MOUNTING BRACKETS & END CAPS

7-	2" X 6-1/2" INSIDE BRACKET
8-	RAFTER TO BEAM BRACKET
9-	TOP POST BRACKET
10-	BOTTOM POST BRACKET
11-	2" X 6-1/2" END CAP
12-	3" X 8" END CAP
13-	2" X 2" SQ. TUBE END CAP

HARDWARE

14-	#10 X 1-1/4" SMS (A) or #12 X 2-1/2" SMS (B)
15-	#8 X 5/8" TEK SCREW
16-	1/4" X 3/4" TEK SCREW
17-	#14 X 3/4" SMS
18-	3/8" X 2-3/4" WEDGE ANCHOR
19-	#8 X 2-1/2" SMS W/ NEOPRENE WASHER
20-	5/8" PLASTIC PLUGS
21-	5/16" X 5-1/2" LAG SCREW W/ WASHER
22-	ANGLE BRKT (FASCIA ATTACHMENT ONLY)

HARDWARE

#12 X 2-1/2" SMS



#8 X 5/8" TEK SCREW



#10 x 1-1/4" SMS



1/4" X 3/4" TEK SCREW



1/4" X 3/4" SMS



#8 X 2-1/2" SMS W/ NEOPRENE WASHER



3/8" X 2-3/4" WEDGE ANCHOR

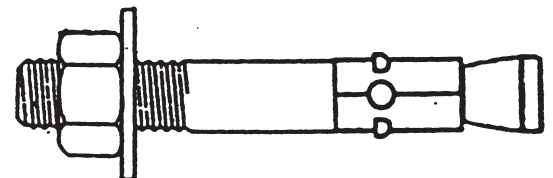

5/16" X 5-1/2" LAG SCREW W/ WASHER

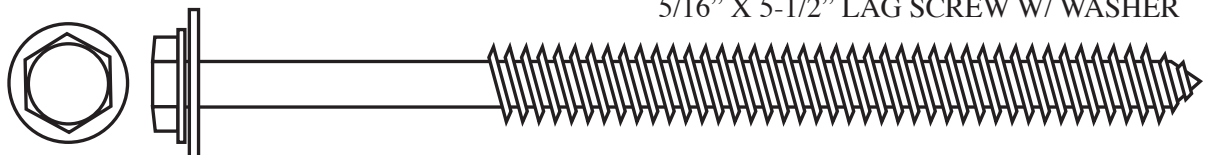

INSTALLATION NOTES: INSTALLATION OF YOUR LATTICE PATIO COVER WILL BE SIMPLIFIED IF IT IS ASSEMBLED IN THE FOLLOWING ORDER. READ ALL INSTALLATION INSTRUCTIONS AND FAMILIARIZE YOURSELF WITH ALL THE PARTS & PIECES BEFORE GETTING STARTED.

THERE ARE TWO BASIC METHODS FOR ATTACHING YOUR LATTICE PATIO COVER

METHOD #1: INSTALLING A LEDGER BOARD KIT AT HOUSE WALL USING 5/16" X 5-1/2" HEX HEAD LAG SCREWS AT EACH STUD LOCATION @ 16" ON CENTER.

METHOD #2: ATTACHING DIRECTLY TO EXISTING FASCIA BOARD: ANGLE BRACKETS MUST BE INSTALLED AT EACH EXISTING EAVE RAFTER TO FASCIA BOARD. LATTICE RAFTERS MAY NEED TO BE CUT AT A SLIGHT ANGLE TO COMPENSATE THE EXISTING ANGLE ON FASCIA.

RECOMMENDED TOOLS:

- * 6' OR 8' STEP LADDER
- * 3/8" VARIABLE SPEED DRILL
- * HACKSAW OR CIRCULAR SAW
WITH FINE TOOTH BLADE
- * EXTENSION CORD
- * LEVEL
- * CARPENTERS SQUARE
- * 25' TAPE MEASURE
- * CHALK LINE
- * HAMMER
- * ADJUSTABLE WRENCH
- * DRIVER / DRILL BIT PKG.
(INCLUDED WITH KIT)
- 1/4", 5/16", 3/8"-3/8" MASONRY, 5/8" SPADE BIT

METHOD #1-(LEDGER BOARD ATTACHMENT) ***METHOD #2**-(SEE FASCIA BOARD ATTACHMENT SHEET)

STEP-1 LEDGER & RAFTER HANGERS

SELECT MOUNTING AREA ON HOUSE WALL, SNAP A LEVEL CHALK LINE ALONG WALL AT DESIRED LEDGER HEIGHT. (MIN. 88" TO UNDERSIDE OF LEDGER)

ATTACH THE LEDGER BOARD TO HOUSE WALL, USING 5/16" X 5-1/2" HEX HEAD LAG SCREWS @ 16" ON CENTER.

LOCATE THE FIRST RAFTER HANGER 12" ON CENTER FROM EDGE OF LEDGER BOARD AND MOUNT WITH 3 EACH #10 X 1-1/4" SMS. LOCATE ADDITIONAL RAFTER HANGERS ON 24" CENTERS.

STEP-2 RAFTER TO BEAM BRACKETS

NOTE: IF BEAM AND POST ASSEMBLY IS ON A CONCRETE SLAB OR OTHER ROUGH SURFACE. SPREAD A PLASTIC TARP OR CARDBOARD ON SURFACE TO PREVENT SCUFFING OR SCRATCHING OF PAINT DURING ASSEMBLY.

ATTACH THE RAFTER TO BEAM BRKT. TO THE TOP OF THE 3" X 8" HEADER BEAM (SEAM TOWARDS THE TOP SIDE) USING 4 EACH #8 X 5/8" TEK SCREWS PER BRKT. THESE BRKTS. SHOULD BE 12" ON CENTER FROM EACH END WITH 24" ON CENTER SPACING SIMILAR TO THE RAFTER BRKTS ON LEDGER BOARD.

NEXT, ATTACH THE TOP POST BRKT. TO BOTTOM OF 3" X 8" HEADER BEAM. THE TOP POST BRKTS. ARE PLACED 12" ON CENTER IN FROM EACH END (TYP.) OF THE 3" X 8" HEADER BEAM. EACH TOP POST BRKT. IS SECURED WITH 4 EACH #14 X 3/4" SMS THROUGH TOP POST BRKT. INTO 3" X 8" HEADER BEAM.

IF MORE THAN TWO POST ARE REQUIRED, CALCULATE SPACING NEEDED BETWEEN POST AS SHOWN IN THE EXAMPLE: 18' BETWEEN POST.

FOR MAX POST SPACING REFER TO ENGINEERING

NO. OF POST REQUIRED	SPACING	FACTOR ÷	BETWEEN POST
3 EA.	18"	2	= 9'
4 EA.	18"	3	= 6'

NOTE: THE DIVISION FACTOR FOR THE NUMBER OF POSTS REQUIRED REMAINS THE SAME REGARDLESS OF DISTANCE BETWEEN THE OTHER POST.

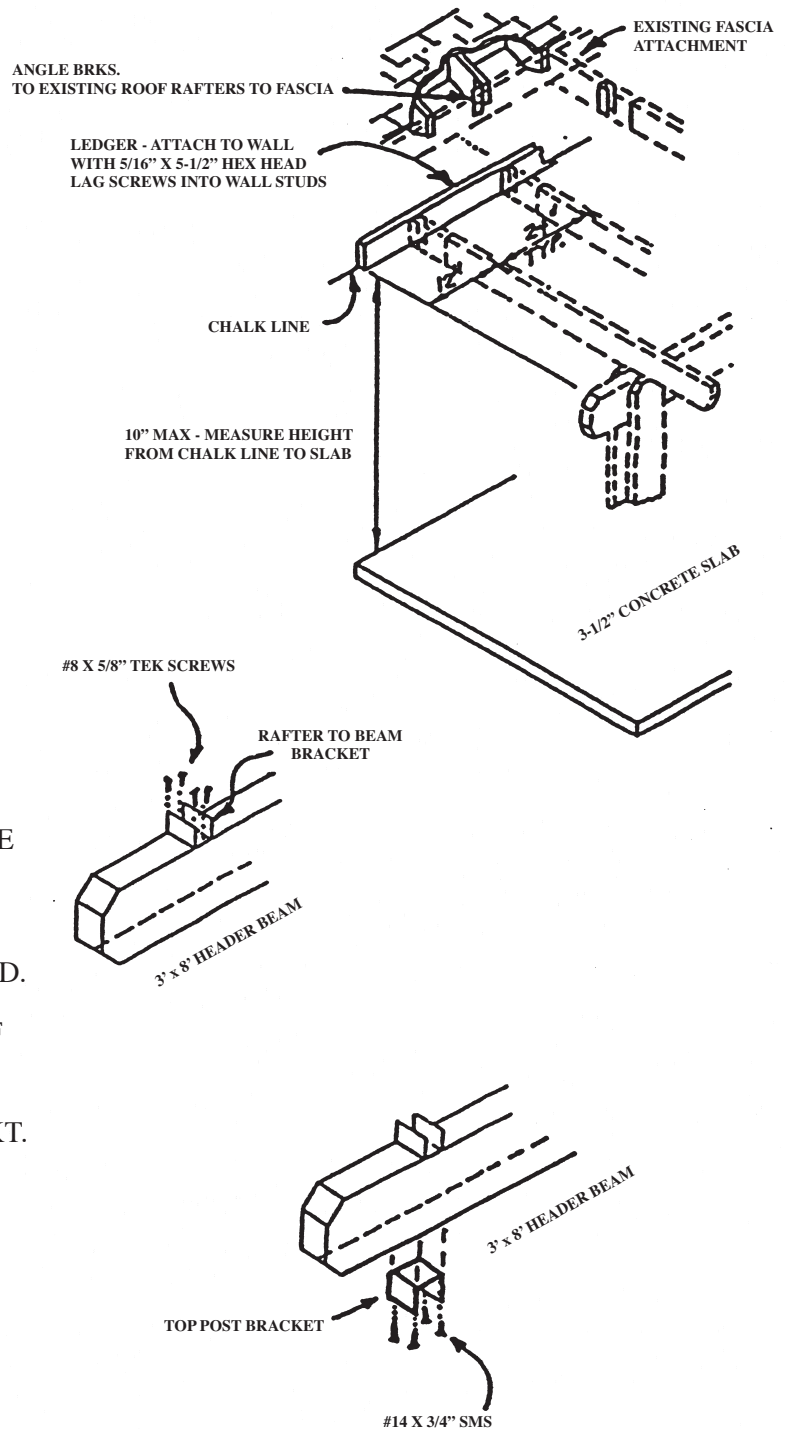

STEP-3 POST ASSEMBLY

NOW FASTEN THE BOTTOM POST BRKT. TO THE 3" X 3" SQ. POST WITH 4 EACH 1/4" X 3/4" TEK SCREWS, 2 EACH SIDE.

TO DETERMINE THE LENGTH OF THE 3" X 3" SQ. POST, FIRST MEASURE THE DISTANCE FROM THE CONCRETE SLAB TO THE BOTTOM OF THE RAFTER HANGER PREVIOUSLY INSTALLED. THEN SUBTRACT 8" TO ALLOW FOR THE HEIGHT OF THE 3" X 8" HEADER BEAM. WHEN FINISHED, THE TOP OF THE 3" X 8" HEADER BEAM SHOULD BE LEVEL WITH THE BOTTOM OF THE RAFTER HANGERS. THE HEADER BEAM SHOULD ALSO BE LEVEL FROM END TO END.

NOTE: IF YOUR CONCRETE SLAB HAS SLOPE IN IT AND IS NOT LEVEL, THE POST WILL HAVE TO BE VARIOUS LENGTHS TO COMPENSATE FOR THE UNEVEN SURFACE.

NOW ATTACH PREVIOUSLY CUT 3" X 3" SQ. POST TO 3" X 8" HEADER BEAM WHILE STILL ON THE GROUND. SECURE WITH 4 EACH 1/4" X 3/4" TEK SCREWS, 2 EACH SIDE.

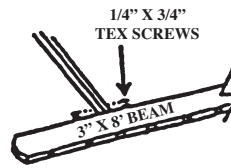
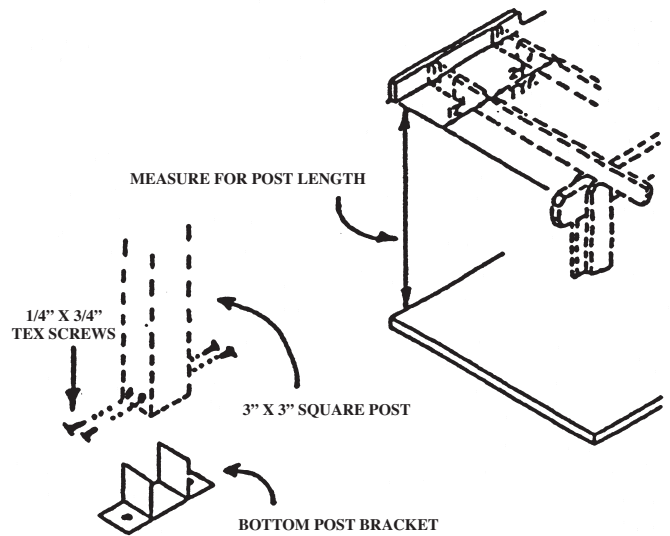

STEP-4 RAISE POST & HEADER BEAM ASSEMBLY

RAISE THE POST AND HEADER BEAM ASSEMBLY FROM GROUND.

NOTE: ALL SEAMS ON RAFTERS ARE TO FACE TOWARDS THE TOP SIDE.

ATTACH ONE RAFTER TO EACH END OF 3" X 8" HEADER BEAM AND TO EACH END RAFTER HANGER AT LEDGER LOCATION. FASTEN WITH 4 EACH #8 X 5/8" TEK SCREWS. 2 EACH SIDE. RAFTERS SHOULD EXTEND PAST 3" X 8" HEADER BEAM. (12" TYP.)

AT THIS POINT, MOVE THE POST AND 3" X 8" HEADER BEAM TO INSURE THAT THE END RAFTERS ARE SQUARE WITH BUILDING.

AFTER THE UNIT IS SQUARE WITH THE BUILDING, THE NEXT STEP IS TO PLUMB THE POST IN BOTH DIRECTIONS. NOW DRILLING A 3/8" HOLE WITH MASONRY BIT, FASTEN TO SLAB WITH 3/8" X 2-3/4" WEDGE ANCHOR. (TIGHTEN ANCHOR BOLTS)

AFTER ALL POSTS ARE PLUMBED AND ANCHORED IN PLACE, THE REMAINING RAFTERS CAN NOW BE INSTALLED AND SECURED IN THE SAME MANNER AS THE END ONES.

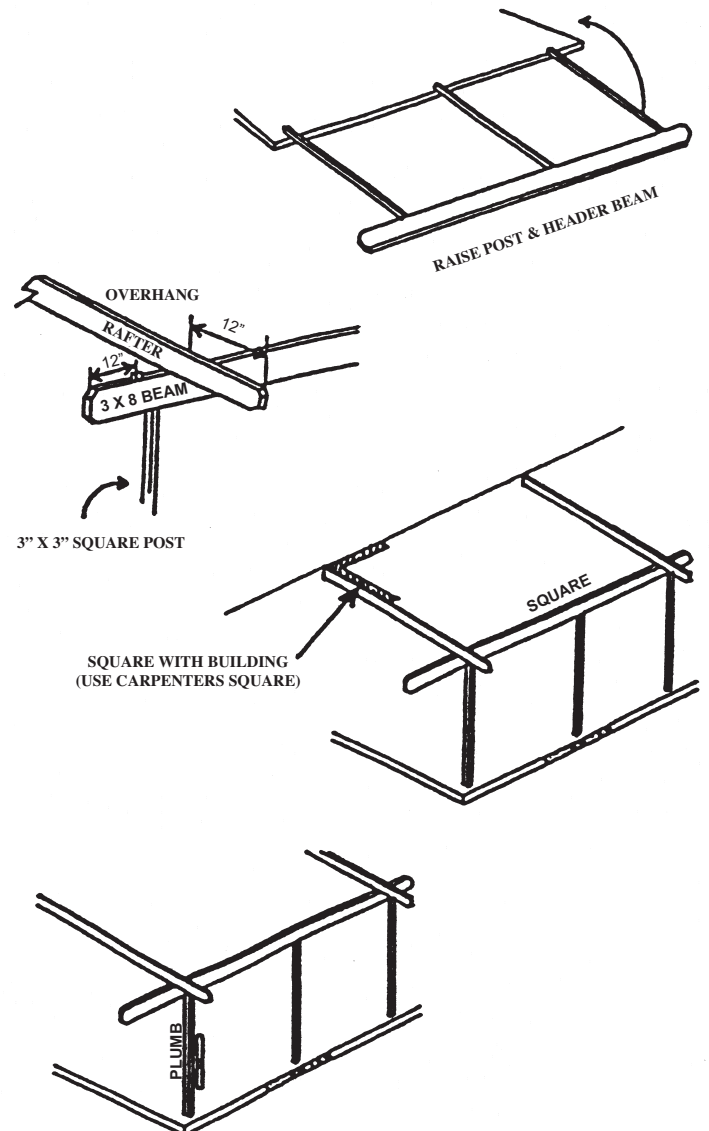

STEP-5 FOAM FILLED SIDE PLATE INSTALLATION

PRIOR TO INSTALLING SIDE PLATES TO POST, PUT 2" X 6-1/2" END CAPS ON MITERED END. THE 2" X 6-1/2" FOAM FILLED SIDE PLATES SHOULD BE CUT 8" TALLER THAN THE 3" X 3" SQ. POST (MITERED END ON TOP SIDE). WHEN DRILLING HOLES IN SIDE PLATES, LAY TWO SIDE PLATES NEXT TO EACH OTHER WITH THE SEAMS FACING EACH OTHER. THIS WILL ALLOW FOR THE SEAMS TO RUN IN THE SAME DIRECTION ON ALL OF THE SIDE PLATES ONCE INSTALLED. SEVEN TO NINE 5/8" DIAMETER HOLES ARE DRILLED THROUGH ONE FACE AND THE FOAM IN EACH SIDE PLATE. **DO NOT** DRILL THROUGH THE BACKFACE. NEXT, FASTEN 2 EACH #8 X 5/8" TEK SCREWS TO THE BACKSIDE OF SIDE PLATE TO SECURE THE 2 X 6 END CAP TO SIDE PLATE.

ATTACH SIDE PLATE TO 3" X 3" SQ. POST AND 3" X 8" HEADER BEAM WITH #14 X 3/4" SMS. INSERT THE 5/8" PLASTIC PLUGS AFTER ALL THE SIDE PLATES ARE PROPERLY FASTENED.

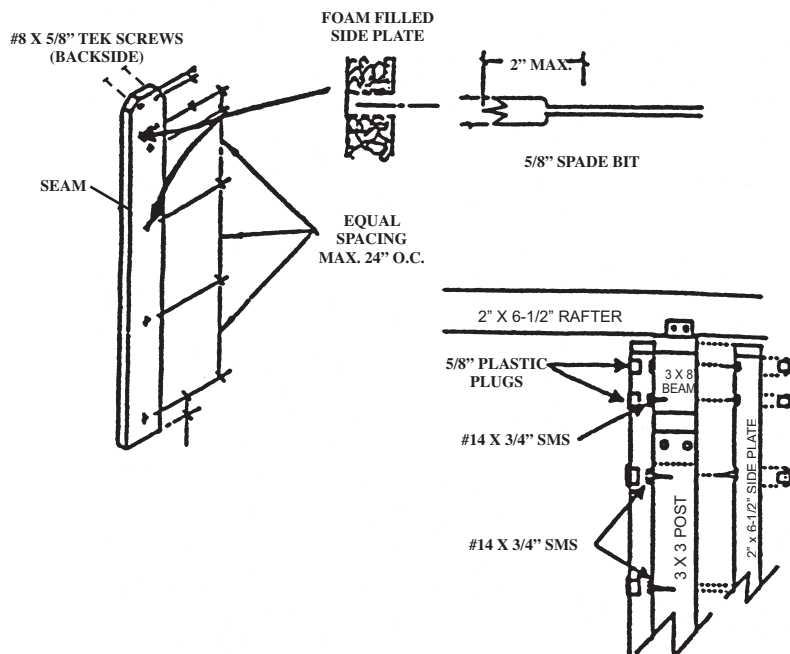

STEP-6 LATTICE TUBE INSTALLATION

STARTING 2" AWAY FROM LEDGER BOARD, INSTALL THE LATTICE TUBES WITH 2" SPACING BETWEEN EACH LATTICE TUBE. MEASURING AT EACH END OF LATTICE TUBE TO ENSURE BOTH SIDES HAVE EQUAL OVERHANG. PLACE THE 2" X 2" LATTICE TUBE SO THAT ALL THE SEAMS FACE TOWARDS THE TOP SIDE. SECURE TUBES USING THE #8 X 2-1/2" SMS WITH NEOPRENE WASHERS TO EACH RAFTER.

HELPFUL HINT: BY LAYING OUT A FEW 2" X 2" TUBES AT A TIME AND SECURING EVERY OTHER TUBE THIS WILL BE 4" ON CENTER WITH 2" SPACING BETWEEN TUBES.

THE REMAINDER OF ALL THE 2" X 6-1/2", 3" X 8" AND 2" X 2" END CAPS CAN NOW BE INSTALLED.

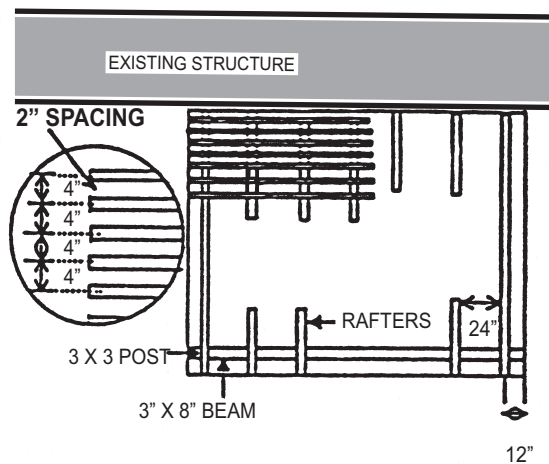

**CONGRATULATIONS!
YOU HAVE JUST COMPLETED
THE INSTALLATION OF YOUR
LATTICE PATIO COVER**

METHOD #2 FASCIA BOARD ATTACHMENTS

STEP-1 EXISTING FASCIA & RAFTER HANGERS

LOCATE THE FIRST RAFTER HANGER 12" ON CENTER FROM THE EDGE OF YOUR STARTING POINT AND MOUNT WITH 3 EACH #10 X 1-1/4" SMS. LOCATE ADDITIONAL RAFTER HANGERS ON 24" CENTERS. *STARTING POINT* = DESIRED LOCATION OF PATIO COVER ON FASCIA BOARD.

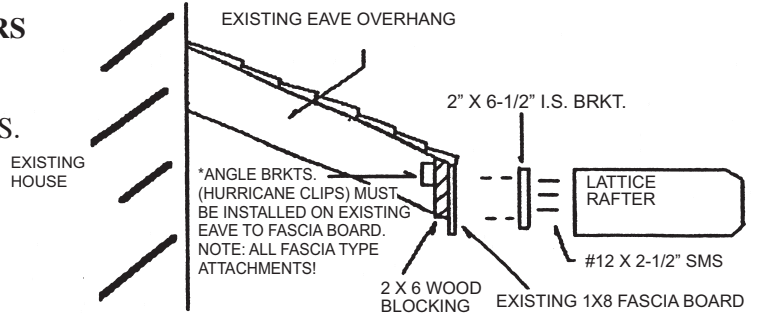

IF EXISTING FASCIA BOARD IS A 1 X 8 FASCIA, THEN A 2 X 6 WOOD BLOCKING MUST BE NAILED TO EXISTING EAVE RAFTERS. THIS WILL ALLOW YOU TO HAVE A SECURE MOUNTING SURFACE, PENETRATING THROUGH THE 1 X 8 FASCIA AND INTO THE 2 X 6 BLOCKING.

DIAGRAM (A)

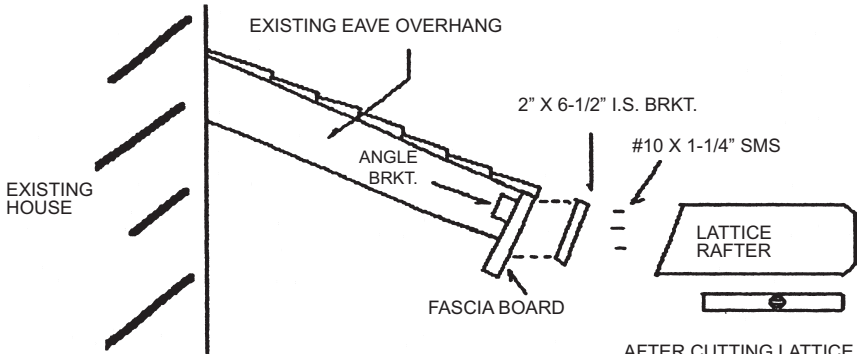

AFTER CUTTING LATTICE RAFTERS ON ANGLE, THEY MUST FINISH LEVEL

DIAGRAM (B)

DIAGRAM (C)

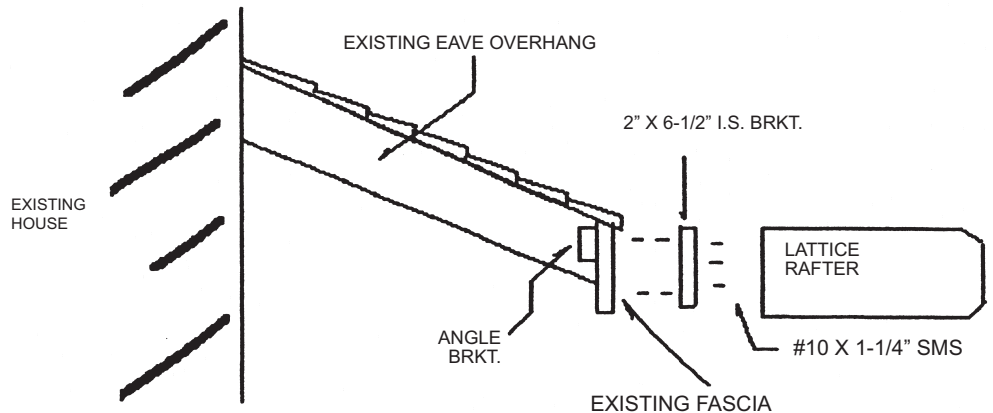
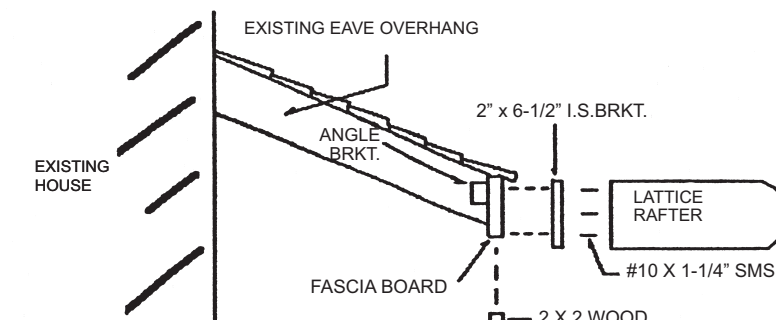

DIAGRAM (D)



* IF FASCIA BOARD IS NOT LARGE ENOUGH FOR THE RAFTER HANGERS A PIECE OF 2X2 WOOD MAY BE SCREWED TO UNDERSIDE OF EXISTING FASCIA BOARD.

GALVANIZED DRYWALL SCREWS

CONTINUE WITH STEP #2 RAFTER TO BEAM BRKT.